

- NOTE(S):
 1. PART NUMBER, "/00" DENOTES PART SHALL HAVE FINISH.
 2. APPLY NSF COMPLIANT GREASE TO ANY O-RING, SEALING JOINTS, AND/OR PIVOTAL POINTS. **G**
 3. APPLY NSF COMPLIANT LOCTITE TO THREADED AREA. **L**
 4. APPLY NSF COMPLIANT REMOVABLE (BLUE) LOCTITE TO THREADED AREA. **B**
 5. SILVER SOLDER JOINTS SHALL BE FULLY WETTED VIA CAPILLARY ACTION AND COMPLETELY NON-POROUS. **S**

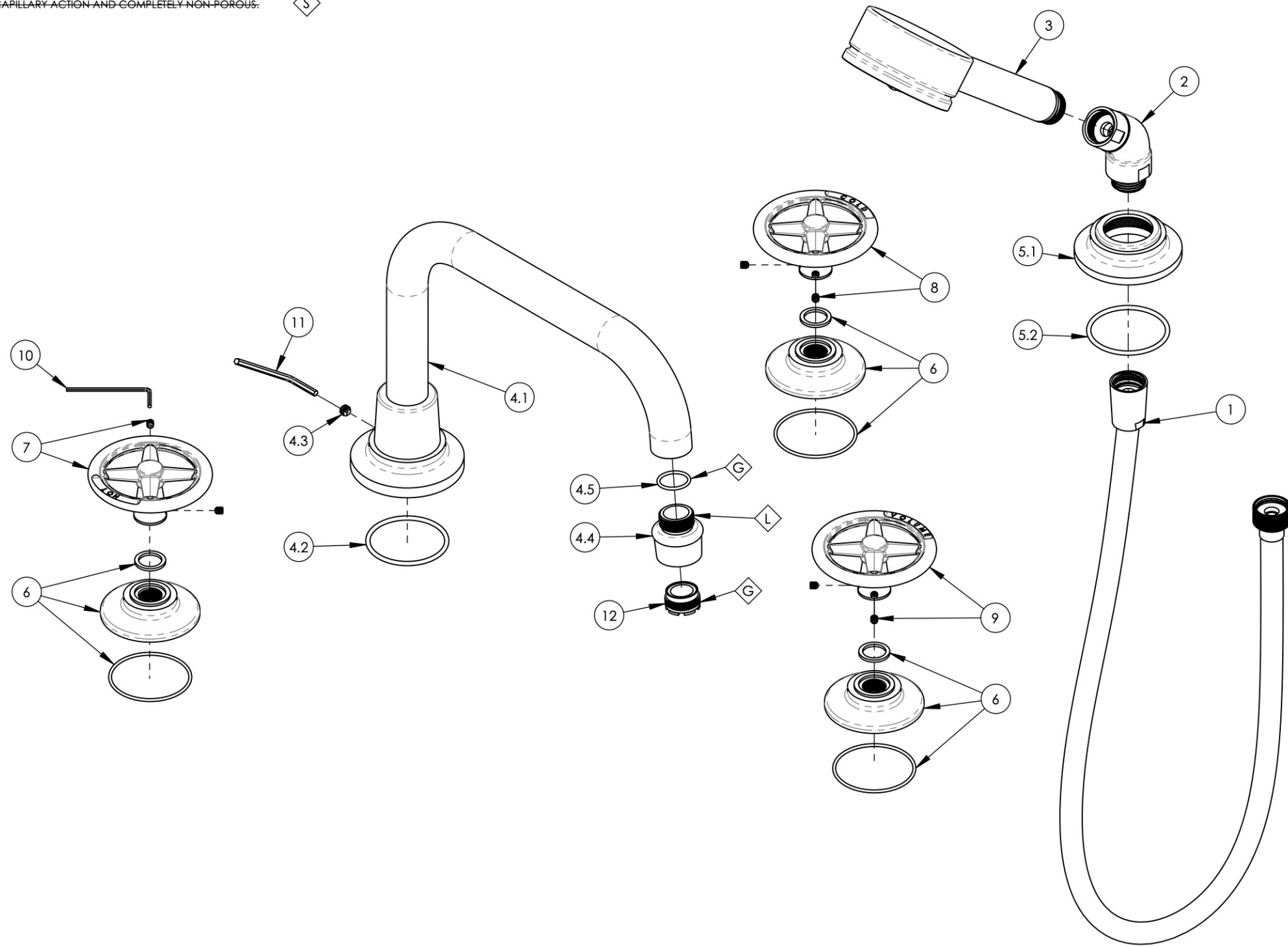

ITEM NO.	PART NUMBER	DESCRIPTION	QTY.
1	3-049/00	ASSY, HOSE KIT, HANDSHOWER	1
2	3-050/00	ELBOW ASSEMBLY	1
3	3-066/00	HANDSHOWER, SINGLE FUNCTION STILO 70	1
4	3-297/00	SPOUT, DECK TUB, LOW FLAT, TRADITIONAL, WORKS	1
4.1	2-349/00	SPOUT, DECK TUB, LOW FLAT, TRADITIONAL, BRAZE, WORKS	1
4.2	90133	1 3/4" O-RING, 1-13/16 ID X 3/32 THK, AS-568-133	1
4.3	92391	SET SCREW, CUP PT. 1/4"-20 X 3/16" L	1
4.4	11674/00	AERATOR HOUSING, RT SPOUT, TRANS. HEX MODERN	1
4.5	90017	O-RING, 11/16 ID X 13/16 OD X 1/16 THK, AS-568-017	1
5	3-298/00	ESCUTCHEON BASE, HANDSHOWER, WORKS	1
5.1	11971/00	ESCUTCHEON BASE, HANDSHOWER, WORKS	1
5.2	90133	1 3/4" O-RING, 1-13/16 ID X 3/32 THK, AS-568-133	1
6	3-299/00	ESCUTCHEON BASE FOR HANDLE, WORKS	3
7	3-300/00	HANDLE CROSS, HOT, W/ HARDWARE, WORKS	1
8	3-301/00	HANDLE CROSS, COLD, W/ HARDWARE, WORKS	1
9	3-302/00	HANDLE CROSS, VOLUME, W/ HARDWARE, WORKS	1
10	92021	HEX KEY 5/64, FOR 8-32 SET SCREW	1
11	92216	HEX L-KEY 1/8" HEX X 2-5/16" L	1
12	P05024	AERATOR CACHE COIN SLOT, M21.5X1.0 FULL FLOW	1

ZONE	REV.	DESCRIPTION	DATE	APPROVED
REVISIONS				

1261 LOGAN AVENUE
 COSTA MESA, CALIFORNIA 92626
 PHONE: 714.361.4800
 FAX: 714.617.3120

PHYLIRICH[®]
 Defining Luxury Since 1959

PROPRIETARY AND CONFIDENTIAL
 THE INFORMATION CONTAINED IN THIS DRAWING IS THE SOLE PROPERTY OF PHYLIRICH. ANY REPRODUCTION IN PART OR AS A WHOLE WITHOUT THE WRITTEN PERMISSION OF PHYLIRICH IS PROHIBITED.
DO NOT SCALE DRAWING

DECK TUB W/ HANDSHOWER SET, LOW SPOUT W/ CROSS, WORKS

SIZE B	ASM/PRT NO. 220-50/00	REV -
SCALE: 1:3	WEIGHT: lbs.	SHEET 1 OF 2