

ITEM NO.	PART NUMBER	DESCRIPTION	QTY.
1	11050	MOUNTING KIT, WALL FLANGE	2
2	11277/00	ESCUTCHEON, ACCESSORIES, MAISON	2
3	11282/00	POST, TOWEL BAR, MAISON SERIES3/4"	2
4	2-039/00	ASSY, POP-UP COURONNE SERIES	2
5	92008	SET SCREW, CUP POINT 8-32	2
6	92043	SCREW, FLAT HD #10 SIZE W/ #2 PHIL DRIVE, 2"L	2
7	92046	ANCHOR SCREW 3/8" HOLE, TOGGLER AF10	2
8	92249	FLAT HD. PHILLIPS, 10-24 7/8" LONG	2
9	P23075/00	30" KLD TOWEL BAR	1

A

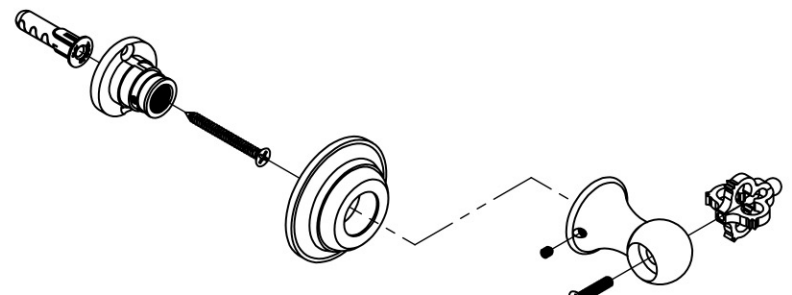

B

C

D

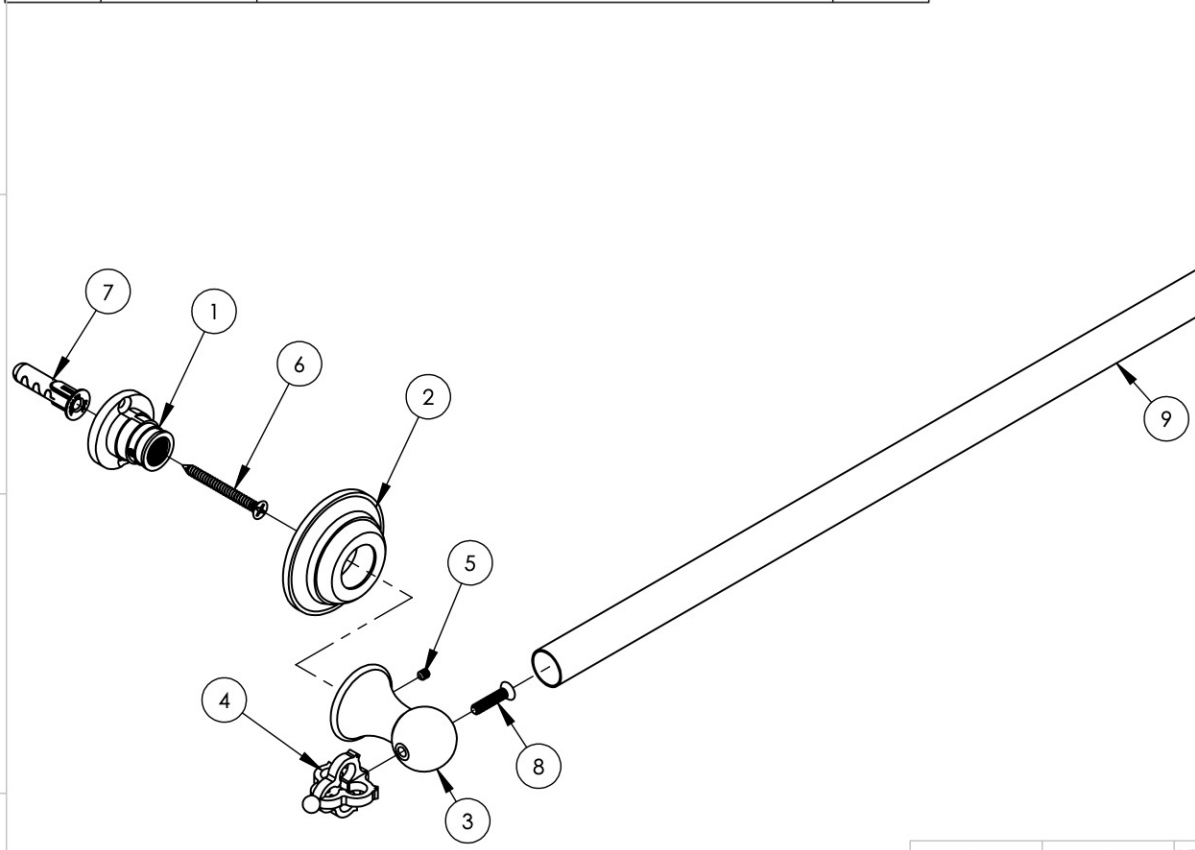

E

ZONE	REV.	DESCRIPTION	DATE	APPROVED
REVISIONS				

1261 LOGAN AVENUE  
COSTA MESA, CALIFORNIA 92626  
PHONE: 714.361.4800  
FAX: 714.617.3120



**RSS MANUFACTURING**

**PROPRIETARY AND CONFIDENTIAL**  
THE INFORMATION CONTAINED IN THIS DRAWING IS THE SOLE PROPERTY OF RSS MANUFACTURING. ANY REPRODUCTION IN PART OR AS A WHOLE WITHOUT THE WRITTEN PERMISSION OF RSS MANUFACTURING IS PROHIBITED.

-	-	INTERPRET GEOMETRIC DIMENSIONING & TOLERANCING IN ACCORDANCE WITH ASME Y14.5-2009 & ASME Y14.41-2003 STANDARDS, UNLESS OTHERWISE SPECIFIED. DIMENSIONS ARE IN INCHES. TOLERANCES ARE:		
NEXT ASSY	USED ON	<b>FRACTIONS</b> ±1/64"	<b>DECIMALS</b> X.X: ±.1 X.XX: ±.01 X.XXX: ±.005	<b>ANGULAR</b> ±.5°
APPLICATION		MATERIAL	NAME	DATE
FINISH		DRAWN	LLO	10/22/2015
<b>DO NOT SCALE DRAWING</b>		CHECKED	GRE	

<b>30" TOWEL BAR, COURONNE SERIES</b>			
SIZE	ASM/PRT NO.	REV	
<b>A</b>	163-72/00	-	
SCALE: 1:3.5	WEIGHT: lbs.	SHEET 1 OF 2	

5

4

3

2

1